

JBC

www.jbctools.com

INSTRUCTION MANUAL



JNAE

High Precision Hot Air Station

Packing List

The following items are included:



JNAE Control Unit1 unit
Ref. JNAE-A (85V -265V)



Stand1 unit
Ref. NA-SA



Heater Hose Set1 unit
Ref. NH-A



Pedal..... 1 unit
Ref. P-405



Pick & Place1 unit
Ref. T260-A



Heating Element.....1 unit
Ref. J125012

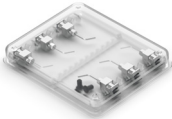

**Matalic Needles and
Cups Set** 1 unit
Ref. 0026490



Power Cord 1 unit
Ref. 0023715 (120V)
0023714 (230V)
0024092 (100V)



Cartridge Holder 1 unit
Ref. SCH-A

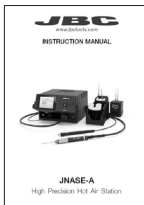

Manual1 unit
Ref. 0024293

Features and Connections

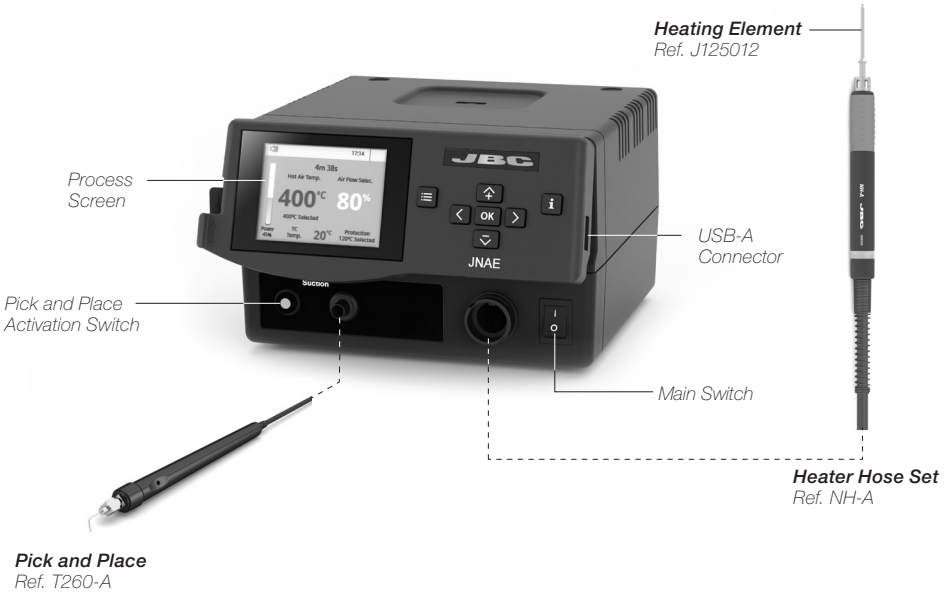

Changing Cartridges

Save time and change cartridges safely without switching the station off.

1. Removing

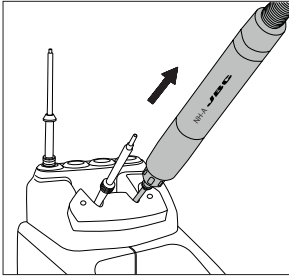

Place the Cartridge in the extractor and pull the handle to remove it.

2. Inserting

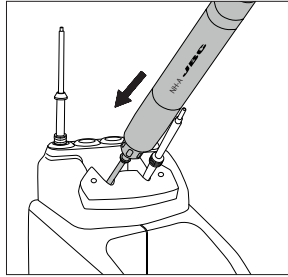

Place the handpiece on top of the new Cartridge and press down slightly.

3. Fixing

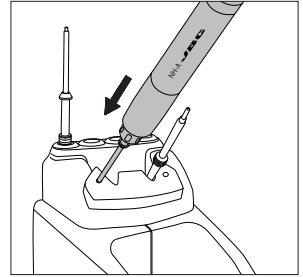

Use the holes to fix the Cartridge.

*Important

It is essential to insert the cartridges as far as the mark for a proper connection.



Compatible Cartridges

The JNASE station works with J125 cartridges and NH-A Heater hose set.

Find the model that best suits your soldering needs in www.jbctools.com

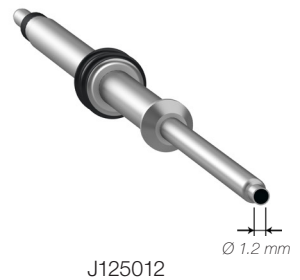
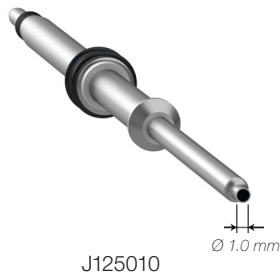
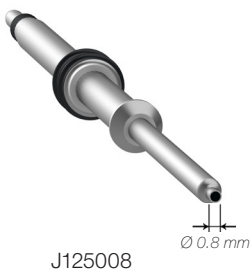

Pick & Place

This tool helps you place and remove SMDs of any size easily thanks to the suction pump.

Pick & Place
Ref. T260-A



Bent Needles and Cups Set*
Ref. 0026490

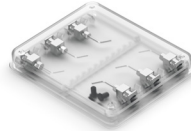

*Set includes the following items (2 units of each reference):

- Ref. 0026637: 20G, 60°, Ø0.60 mm/0,0236 in
- Ref. 0026639: 30G, 60°, Ø0.159 mm/0.00626 in
- Ref. 0026638: 25G, 60°, Ø0.26 mm/0.01023 in
- Cup ref. 00940112, used with needle ref. 0026637

Operation

Choose the needle that best fits the component and the suction cup if needed and start as follows:



Press the button to start/stop the suction

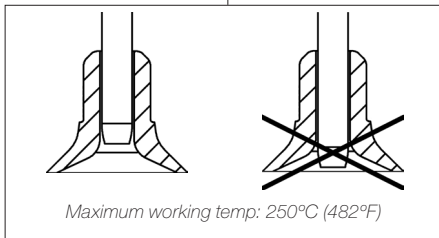

Maximum working temp: 250°C (482°F)

Insert the needle with the cup for a correct suction process.

Make sure the needle does not protrude from the cup.

1. Suction

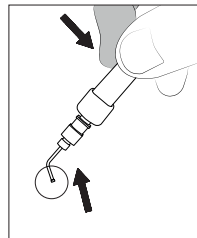

Once the suction is activated, cover the pen hole with your finger and lift off the component.

2. Release

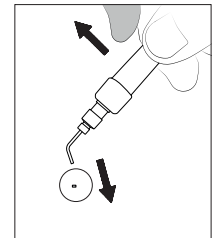

Lift your finger to release the component.

Pedal

By means of the Pedal (ref. P-405) connection the Hot Air Tool and the Suction Tool may be activated and deactivated.

The pedal should be plugged in at the rear of the station into its connector, marked "Pedal", to use the Pedal functionality.

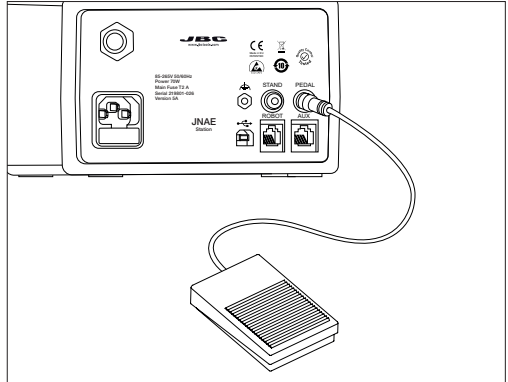

Tool Settings

Start Mode

Select menu  Then by pressing  select "TOOL" and confirm with 

Select "PEDAL FUNCTION" and confirm with OK button. Then choose between "HOT AIR" and "SUCTION". Confirm again with OK button.

Activation Settings

In both applications, Hot Air and Suction, are 2 different pedal activation modes available.

One Touch Mode

Press the pedal once to activate the function. Press again to stop the function.

Pressed Mode

Start the function by pressing the pedal continuously and stop the function by lifting the pedal. The function is active as long as the pedal is kept pressed.

Select "PEDAL" confirm with OK button and choose between PRESS ONCE" and "PRESS CONT". Confirm again with OK button.

JBC Preheaters

For rework jobs the use of preheaters is highly recommended.



Applying high temperatures (350 °C - 450 °C / 660 °F - 840° F) for a long time can damage both, the printed circuit and the electronic components. In addition, significant temperature differences between two points on a PCBA can also damage it due to the stress generated by expansion.

Preheating is a process that minimizes thermal stress and allows the welding process to take no longer than it should.

For most rework processes JBC recommends a preheat temperature between 90 and 130 °C / 195 and 265 °F and not exceed a heating rate of 4 °C/s. With the use of JBC preheaters, a homogeneous and controlled heating is achieved within the recommended parameters.

JNASE Work Screen

The JNASE offers an **intuitive user interface** which provides **quick access** to station parameters.
Default PIN: 0105

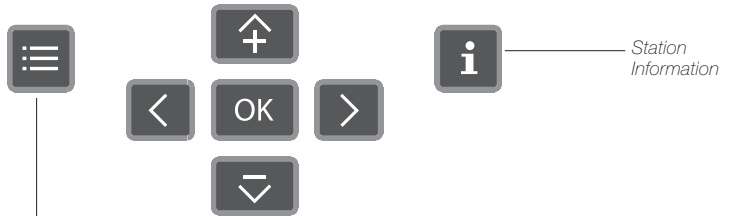
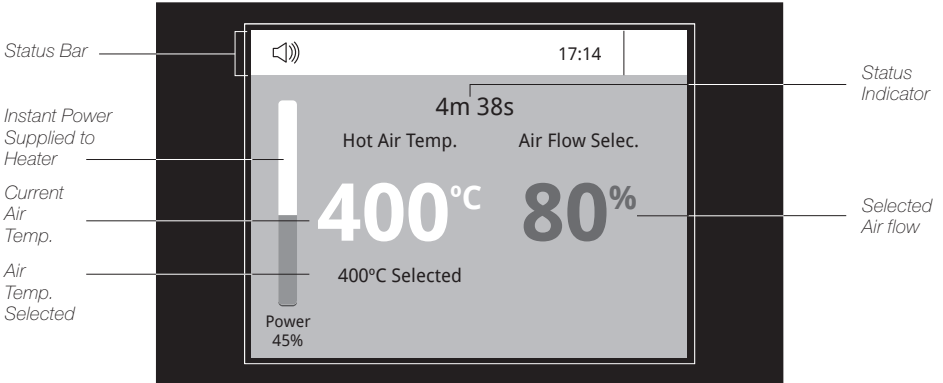

Menu Options



Set the station parameters

Station



Set the tool parameters

Tools



Display the hours worked in each cycle

Counters



It is possible to choose the language from a list.

Language



Allows you to carry out an overall station reset restoring all the parameters to their default values.

Reset

Troubleshooting

Station troubleshooting available on the product page at www.jbctools.com



Update

Station Update

Download the JBC Update File from www.jbctools.com/software.html
Insert the USB flash drive with the file downloaded to the station.

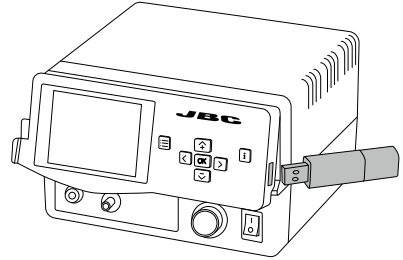

System Notifications

The following icons will be displayed on the screen's status bar.



USB flash drive is connected.



Station is controlled by a PC.



Station is controlled by a robot.

Station software update.



Press INFO to start the process.

Warning.

Press INFO for failure description.



Error.

Press INFO for failure description, the type of error and how to proceed.



Compatible Accessories (*Not included*)

Grips for NH-A (*Ref. 0024473*)

Soft foam grips ensure a better manual control of the tool and greater comfort when working.

Easily replace the Grips for NH-A using the slip-on tabs.

1. Inserting Tabs

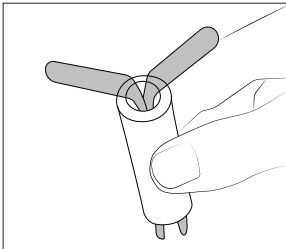

Insert the slide-on tabs into the new grip.

2. Inserting Handle

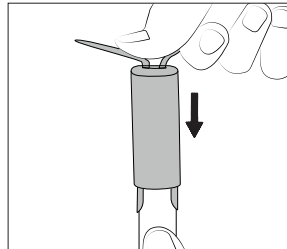

Push the grip with the tabs onto the handle.

3. Removing Tabs

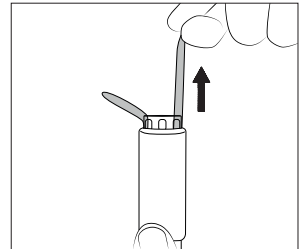

Hold the grip and pull them out. Use a pliers if necessary.

Maintenance

Before carrying out maintenance, always switch the device off and disconnect it from the mains. Allow the equipment to cool down.

- Clean the station screen with a glass cleaner or a damp cloth.
- Use a damp cloth to clean the casing and the tool. Alcohol can only be used to clean the metal parts.
- Periodically check that the metal parts of the tool and stand are clean so that the station can detect the tool status.
- Periodically check all cables and tubes.
- Replace a blown fuse as follows:

1. Pull off the fuse holder and remove the fuse. If necessary use a tool to lever it off.

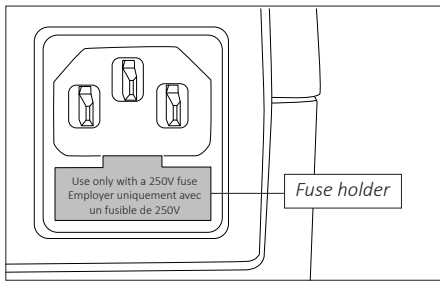

2. Insert the new fuse into the fuse holder and return it to the station.

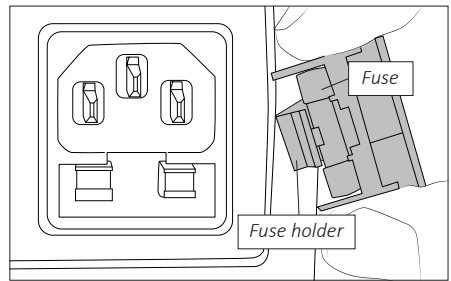

- Replace any defective or damaged pieces. Use original JBC spare parts only.
- Repairs should only be performed by a JBC authorized technical service.

Safety



It is imperative to follow safety guidelines to prevent electric shock, injury, fire or explosion.

- Do not use the units for any purpose other than soldering or rework. Incorrect use may cause fire.
- The power cord must be plugged into approved bases. Make sure that it is properly grounded before use. When unplugging it, hold the plug, not the wire.
- Do not work on electrically live parts.
- The tool should be placed in the stand when not in use to turn off the hot air. The soldering tip, the metal part of the tool and the stand may still be hot even when the station is turned off. Handle with care, including when adjusting the stand position.
- Do not leave the appliance unattended when it is on.
- Do not cover the ventilation grills. Heat can cause inflammable products to ignite.
- Avoid the contact of flux with skin or eyes to prevent irritation
- Be careful with the fumes produced when soldering.
- Keep your workplace clean and tidy. Wear appropriate protection glasses and gloves when working to avoid personal harm.
- Utmost care must be taken with liquid tin waste which can cause burns.
- This appliance can be used by children over the age of eight and also persons with reduced physical, sensory or mental capabilities or lack of experience provided that they have been given adequate supervision or instruction concerning use of the appliance and understand the hazards involved. Children must not play with the appliance.
- Maintenance must not be carried out by children unless supervised.

有害物质含量表

产品中有害物质的名称及含量

部件名称	有害物质					
	铅(Pb)	汞(Hg)	镉(Cd)	六价铬 (Cr(VI))	多溴联苯 (PBB)	多溴二苯醚 (PBDE)
烙铁头	○	○	○	○	○	○
手柄	○	○	○	○	○	○
电源线	○	○	○	○	○	○
主机	○	○	○	○	○	○
电源插座	○	○	○	○	○	○
保险丝	○	○	○	○	○	○
主开关	○	○	○	○	○	○
电位连接	X	○	○	○	○	○
变压器	○	○	○	○	○	○
线路板	X	○	○	○	○	○

○ 表示该有害物质在该部件所有均质材料中的含量均在GB/T 26572 规定的限量要求以下。
X 表示该有害物质至少在该部件的某一均质材料中的含量超出GB/T 26572 规定的限量要求。

Specifications

JNASE-1A 120V 50/60Hz. Main fuse: T2A.

JNASE-2A 230V 50/60Hz. Main fuse: T2A.

JNASE-9A 100V 50/60Hz. Main fuse: T2A.

- Temperature Selection: Room temp. / 150 - 450 °C / 300 - 840 °F
- Nominal Power: 70W
- Cool Mode: Temp. off. Used to blow air at room temperature
- Ambient Operating Temp.: 10 - 50 °C / 50 - 122 °F
- Air Flow Regulation: 0.15 - 2.5 SLPM
- Vacuum: 53% / 397 mmHg / 15.6 inHg
- Connectors: USB-A / USB-B
RJ12 for RS232
Pedal / Stand
- Control Unit Dimensions/Weight: 180 x 170 x 110 mm / 1.346 kg
(L x W x H) 7.1 x 6.7 x 4.3 in / 2.96 lb
- Total Package Dimensions/Weight: 370 x 370 x 200 mm / 4.062 kg
(L x W x H) 14.6 x 14.6 x 7.9 in / 8.95 lb

Complies with CE standards.

ESD protected.

JBC

Warranty

JBC's 2 year warranty covers this equipment against all manufacturing defects, including the replacement of defective parts and labour.

Warranty does not cover product wear or misuse.

In order for the warranty to be valid, equipment must be returned, postage paid, to the dealer where it was purchased.

Get 1 extra year JBC warranty by registering here:
<https://www.jbctools.com/productregistration/>
within 30 days of purchase.



This product should not be thrown in the garbage.

In accordance with the European directive 2012/19/EU, electronic equipment at the end of its life must be collected and returned to an authorized recycling facility.



www.jbctools.com